

Dairy BS 4825 Series Concentric Reducer

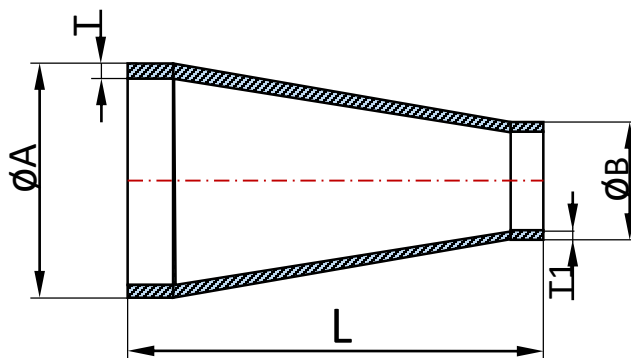

Size	$\varnothing A$	$\varnothing B$	L	T
1 ½" x 1"	38.1	25.4	29	1.65
2" x 1"	50.8	25.4	53	1.65
2" x 1 ½"	50.8	38.1	41	1.65
2 ½" x 1"	63.5	25.4	82	1.65
2 ½" x 1 ½"	63.5	38.1	64	1.65
2 ½" x 2"	63.5	50.8	40	1.65
3" x 1"	76.2	25.4	110	1.65
3" x 1 ½"	76.2	38.1	81	1.65
3" x 2"	76.2	50.8	55	1.65
3" x 2 ½"	76.2	63.5	41	1.65
4" x 1 ½"	101.6	38.1	135	2.10
4" x 2"	101.6	50.8	106	2.10
4" x 2 ½"	101.6	63.5	76	2.10
4" x 3"	101.6	76.2	53	2.10